

# UT | IP54 | U |

가 ,



UT는 U형 보호 캡을 사용하여 케이블을 보호하는 데 사용됩니다. 케이블 직경은 4~11mm 범위입니다.

캡의 두께는 1~4mm 범위입니다.

UT는 다양한 케이블 크기에 맞게 설계되었습니다.

이 제품은 다양한 환경에서 사용할 수 있습니다.

이 제품은 IP54 등급의 방수 성능을 제공합니다.

IP54

HL3  
EN 45545-2

ECOLAB  
certified

UV-  
ISO 4892-2A

RoHS  
compliant

REACH  
COMPLIANCE

Made in  
Germany

## Ausbruch | Cut-out

### Gehäuse mit Nut – Federsystem

Housing with tongue and groove system

Wanddicke | Wall thickness  
1,0 mm – 4,0 mm

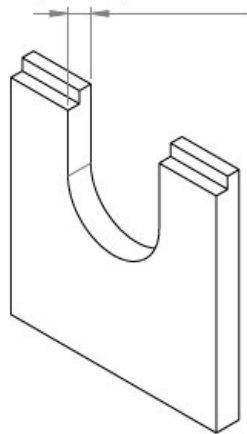

### Gehäuse ohne Nut - Federsystem

Housing without tongue and groove system

Wanddicke | Wall thickness  
1,0 mm – 4,0 mm

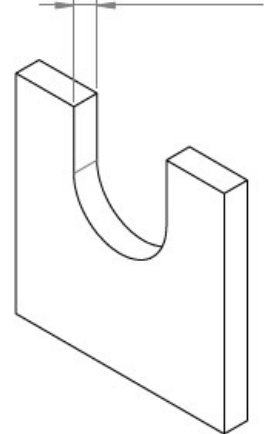

### Ausbruch mit Nut

Cut-out with groove

### Ausbruch ohne Nut

Cut-out without groove

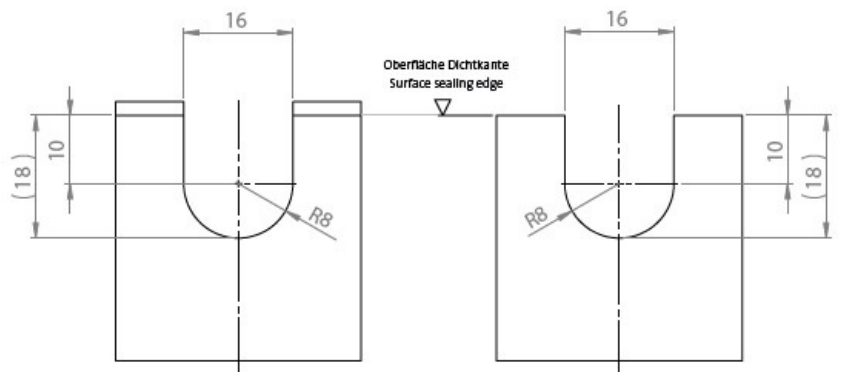

가

가 2mm 이상 두께를 가져야 합니다.

가 보호 캡을 사용하십시오.

가 4~11mm 범위입니다.

가 IP54 등급의 방수 성능을 제공합니다.

가

IP 등급 (EN 60529)

IP54

가

UL94-V0, 가

-40 C° to 100 C°

UV-가, 가, 가

가

가

가

5 mm

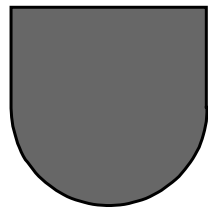

EAN

**56100**  
**4251269335464**  
**10**  
**23,5 mm**  
**23 mm**  
**11 mm**

□□ □□  
□□ □ □□  
□□ □ □□

**5 mm**  
**1 mm**  
**4 mm**

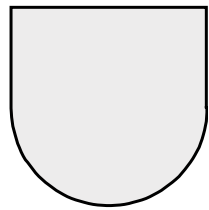

EAN

**56000**  
**4251269335396**  
**10**  
**23,5 mm**  
**23 mm**  
**11 mm**

□□ □□  
□□ □ □□  
□□ □ □□

**5 mm**  
**1 mm**  
**4 mm**  
□□(RAL 7035□ □□)

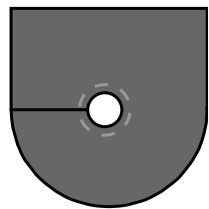

EAN

□□□ □

**56101**  
**4251269335471**  
**10**  
**1**  
**23,5 mm**  
**23 mm**  
**11 mm**

□□ □□  
□□ □ □□  
□□ □ □□

□□□ □□ □

**5 mm**  
**1 mm**  
**4 mm**  
**1 x 4 - 6 mm**

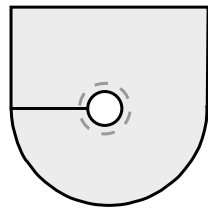

EAN

□□□ □

**56001**  
**4251269335402**  
**10**  
**1**  
**23,5 mm**  
**23 mm**  
**11 mm**

□□ □□  
□□ □ □□  
□□ □ □□

□□□ □□ □

**5 mm**  
**1 mm**  
**4 mm**  
□□(RAL 7035□ □□)  
**1 x 4 - 6 mm**

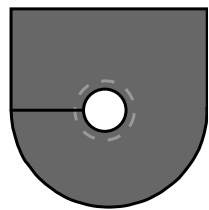

EAN

□□□ □

**56102**  
**4251269335488**  
**10**  
**1**  
**23,5 mm**  
**23 mm**  
**11 mm**

□□ □□  
□□ □ □□  
□□ □ □□

□□□ □□ □

**5 mm**  
**1 mm**  
**4 mm**  
**1 x 5 - 7 mm**

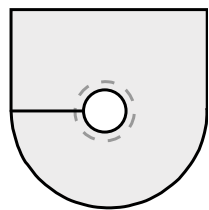

EAN

□□□ □

**56002**  
**4251269335419**  
**10**  
**1**  
**23,5 mm**  
**23 mm**  
**11 mm**

□□ □□  
□□ □ □□  
□□ □ □□

□□□ □□ □

**5 mm**  
**1 mm**  
**4 mm**  
□□(RAL 7035□ □□)  
**1 x 5 - 7 mm**

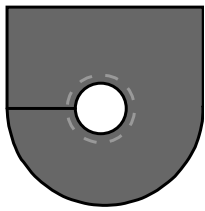

EAN

□□□ □

**56103**  
**4251269335495**  
**10**  
**1**  
**23,5 mm**  
**23 mm**  
**11 mm**

□□ □□  
□□ □ □□  
□□ □ □□  
  
□□□ □□ □

**5 mm**  
**1 mm**  
**4 mm**  
  
**1 x 6 - 8 mm**

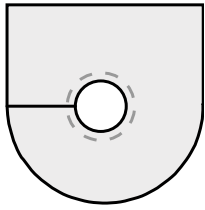

EAN

□□□ □

**56003**  
**4251269335426**  
**10**  
**1**  
**23,5 mm**  
**23 mm**  
**11 mm**

□□ □□  
□□ □ □□  
□□ □ □□  
  
□□□ □□ □

**5 mm**  
**1 mm**  
**4 mm**  
**□□(RAL 7035□ □□)**  
**1 x 6 - 8 mm**

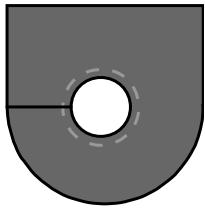

EAN

□□□ □

**56104**  
**4251269335501**  
**10**  
**1**  
**23,5 mm**  
**23 mm**  
**11 mm**

□□ □□  
□□ □ □□  
□□ □ □□  
  
□□□ □□ □

**5 mm**  
**1 mm**  
**4 mm**  
  
**1 x 7 - 9 mm**

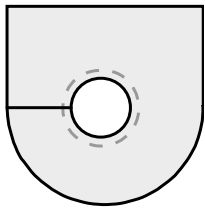

EAN

□□□ □

**56004**  
**4251269335433**  
**10**  
**1**  
**23,5 mm**  
**23 mm**  
**11 mm**

□□ □□  
□□ □ □□  
□□ □ □□  
  
□□□ □□ □

**5 mm**  
**1 mm**  
**4 mm**  
**□□(RAL 7035□ □□)**  
**1 x 7 - 9 mm**

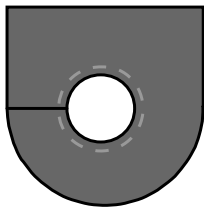

EAN

□□□ □

**56105**  
**4251269335518**  
**10**  
**1**  
**23,5 mm**  
**23 mm**  
**11 mm**

□□ □□  
□□ □ □□  
□□ □ □□  
  
□□□ □□ □

**5 mm**  
**1 mm**  
**4 mm**  
  
**1 x 8 - 10 mm**

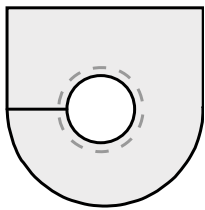

EAN

□□□ □

**56005**  
**4251269335440**  
**10**  
**1**  
**23,5 mm**  
**23 mm**  
**11 mm**

□□ □□  
□□ □ □□  
□□ □ □□  
  
□□□ □□ □

**5 mm**  
**1 mm**  
**4 mm**  
**□□(RAL 7035□ □□)**  
**1 x 8 - 10 mm**

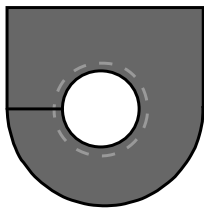

EAN

□□□ □

**56106**  
**4251269335525**  
**10**  
**1**  
**23,5 mm**  
**23 mm**  
**11 mm**

□□ □□  
□□ □ □□  
□□ □ □□  
  
□□□ □□ □

**5 mm**  
**1 mm**  
**4 mm**  
  
**1 x 9 - 11 mm**

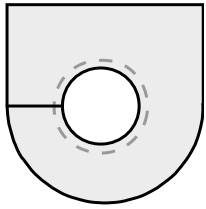

EAN

□□□ □

**56006**  
**4251269335457**  
**10**  
**1**  
**23,5 mm**  
**23 mm**  
**11 mm**

□□ □□  
□□ □ □□  
□□ □ □□  
  
□□□ □□ □

**5 mm**  
**1 mm**  
**4 mm**  
□□(RAL 7035□ □□)  
**1 x 9 - 11 mm**

---

**icotek**<sup>®</sup>  
smart cable management